



IES FLOOD REPORT
PHOTOMETRIC FILENAME : LLI090609C.IES

DESCRIPTIVE INFORMATION (From Photometric File)

IESNA:LM-63-2002
[TEST] LLI 0906-09C
[TESTLAB] LIGHT LABORATORY INC
[ISSUEDATE] 9/20/2006
[MANUFAC] HK LIGHTING GROUP
[LUMCAT] ZX18I-CMH-T4-20MH-WIDE
[LUMINAIRE] 2.5"DIA. X 9"L. X 4.6"H. ACCENT & AREA LUMINAIRE
[MORE] SPUN ALUMINUM WIDE BEAM SPREAD REFLECTOR
[MORE] TEMPERED GLASS LENS
[BALLASTCAT] GE ULTRAMAX-HID GEMH20MLF120
[BALLAST] 120V 50/60Hz ELECTRONIC
[LAMPPOSITION] 0,0
[LAMPCAT] GE CMH20/T/UVC/830/GU6.5
[_LAMPLUM] 1615
[_INPUT] 120VAC, 22.69W

Note: Candela values converted from Type-C to Type-B

CHARACTERISTICS

IES NEMA Type	3 H x 3 V
Maximum Candela	3185
Maximum Candela Angle	0H 0V
Horizontal Beam Angle (50%)	15.4
Vertical Beam Angle (50%)	15.4
Horizontal Field Angle (10%)	29.9
Vertical Field Angle (10%)	29.9
Total Rated Lamp Lumens	1615
Beam Lumens	124.74
Beam Efficiency	7.72%
Field Lumens	242.28
Field Efficiency	15.00%
Total Lumens	365.94
Total Efficiency	22.66%

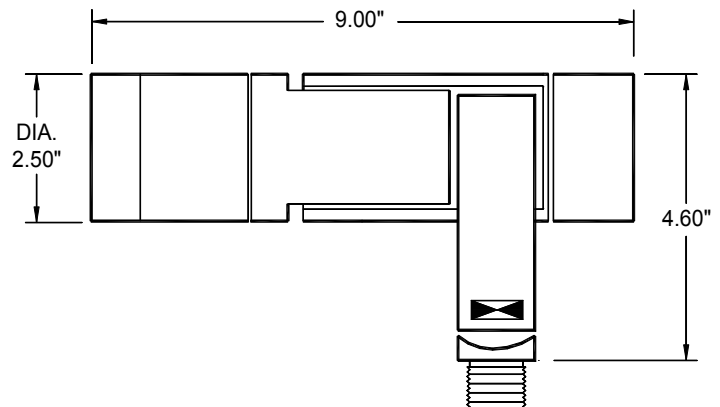

NOTE: ALL TESTS ASSUME BALLAST FACTOR (BF) = 1.0 UNLESS STATED.
IF TEST OR OTHER BALLAST USED HAS A BF OTHER THAN 1.0, ALL
LUMEN, CANDELA, AND LUMINANCE VALUES SHOULD BE MULTIPLIED BY
THE BF, CU, EFFICIENCY AND % FLUX VALUES REMAIN AS LISTED.
TOTAL WATTS VALUE APPLIES ONLY TO TESTED BALLAST.

IES FLOOD REPORT
PHOTOMETRIC FILENAME : LLI090609C.IES

AXIAL CANDELA

DEG.	HOR.	DEG.	VERT.
90	0	90	0
85	0	85	0
75	1	75	1
65	3	65	3
55	7	55	7
47.5	9	47.5	9
42.5	12	42.5	12
37.5	18	37.5	18
33	31	33	31
29	66	29	66
25.5	111	25.5	111
22.5	131	22.5	131
19.5	170	19.5	170
17	227	17	227
15	313	15	313
13	475	13	475
11	734	11	734
9	1187	9	1187
7	1812	7	1812
5	2385	5	2385
3	2787	3	2787
1	3104	1	3104
0	3185	0	3185
-1	3104	-1	3104
-3	2787	-3	2787
-5	2385	-5	2385
-7	1812	-7	1812
-9	1187	-9	1187
-11	734	-11	734
-13	475	-13	475
-15	313	-15	313
-17	227	-17	227
-19.5	170	-19.5	170
-22.5	131	-22.5	131
-25.5	111	-25.5	111
-29	66	-29	66
-33	31	-33	31
-37.5	18	-37.5	18
-42.5	12	-42.5	12
-47.5	9	-47.5	9
-55	7	-55	7
-65	3	-65	3
-75	1	-75	1
-85	0	-85	0
-90	0	-90	0

AXIAL CANDELA DISPLAY

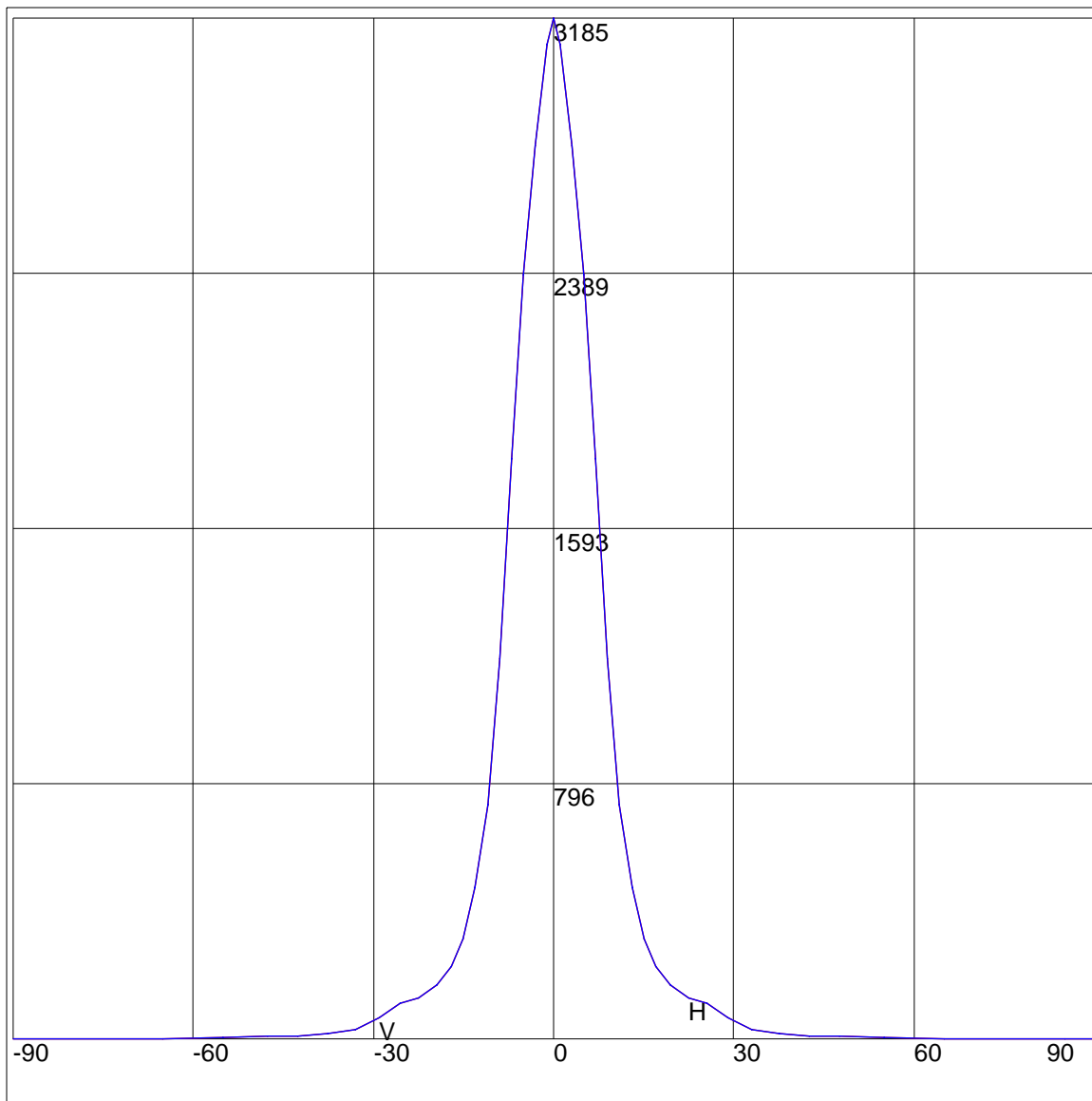

Maximum Candela = 3185 Located At Horizontal Angle = 0, Vertical Angle = 0

H - Horizontal Axial Candela

V - Vertical Axial Candela

ISOCANDELA CURVES

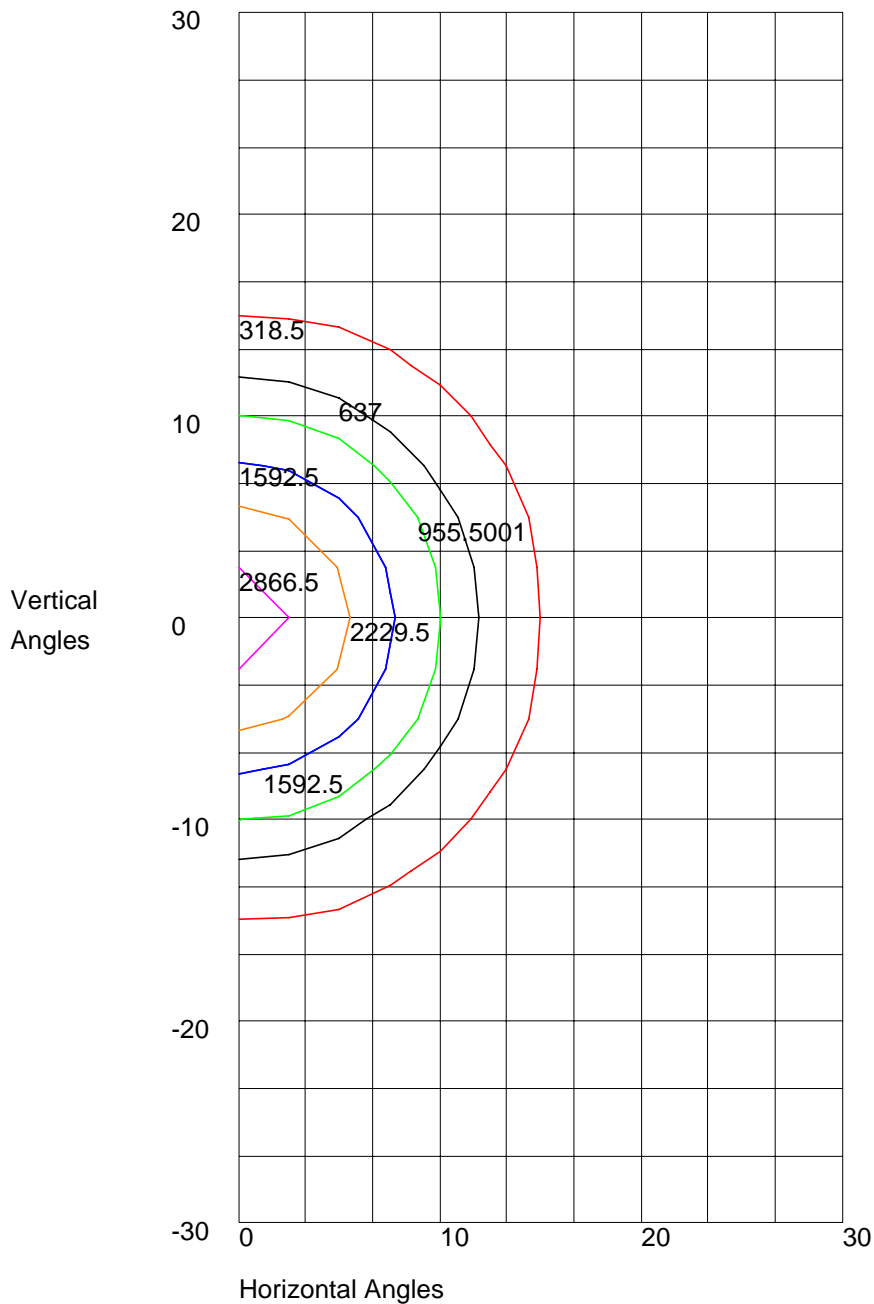

Maximum Candela = 3185 Located At Horizontal Angle = 0, Vertical Angle = 0
 50% Maximum Candela = 1592.5
 10% Maximum Candela = 318.5